

*2014 DISTRICT 2  
SETUP AND PAVE  
DURHAM COUNTY*

*2014 DISTRICT 2  
SETUP AND PAVE  
GRANVILLE COUNTY*

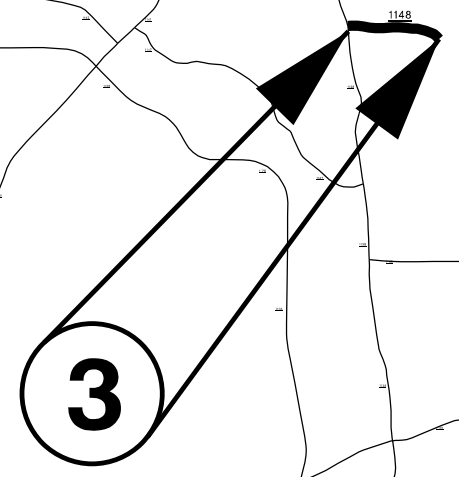

# 2014 DISTRICT 2 SETUP AND PAVE PERSON COUNTY

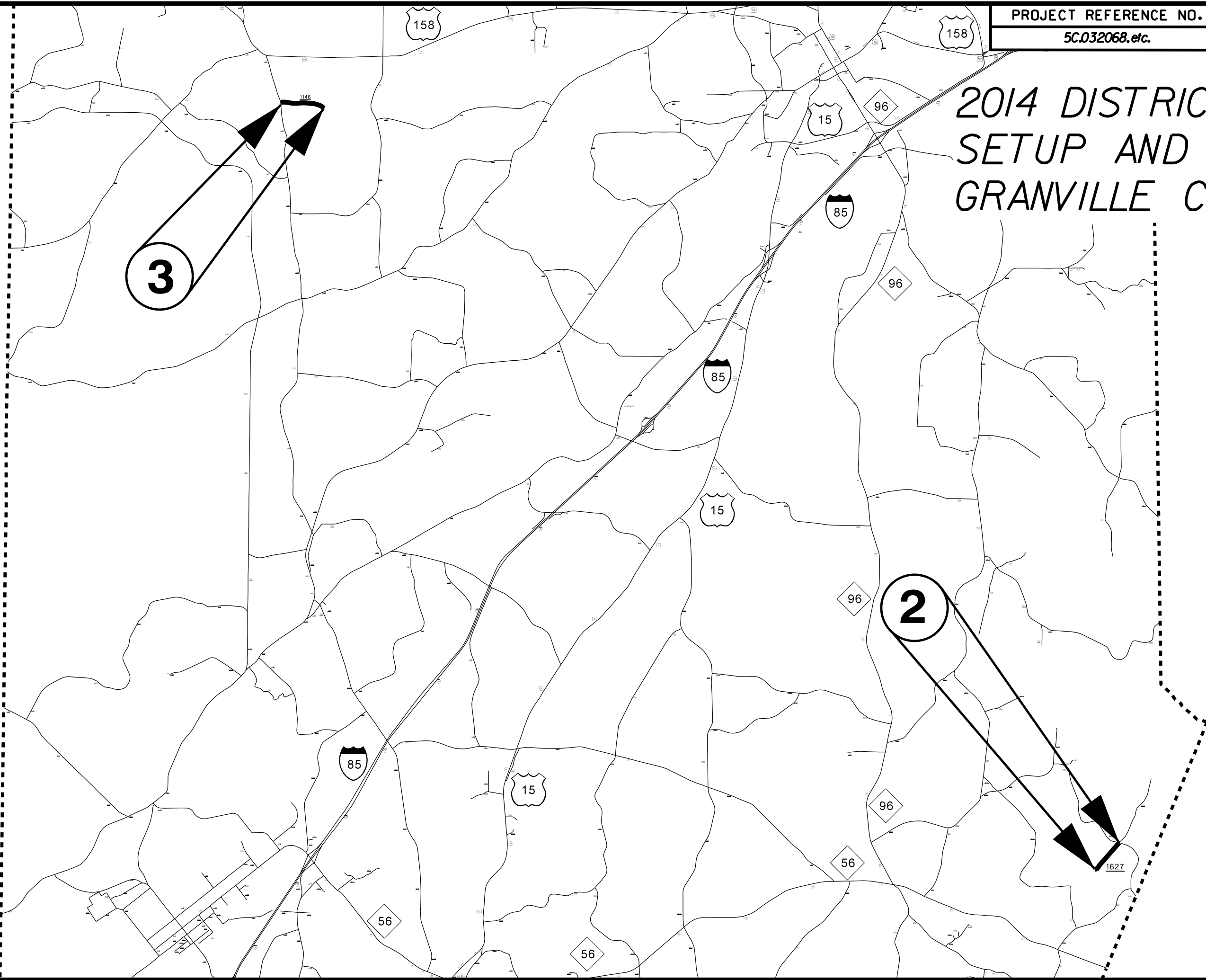
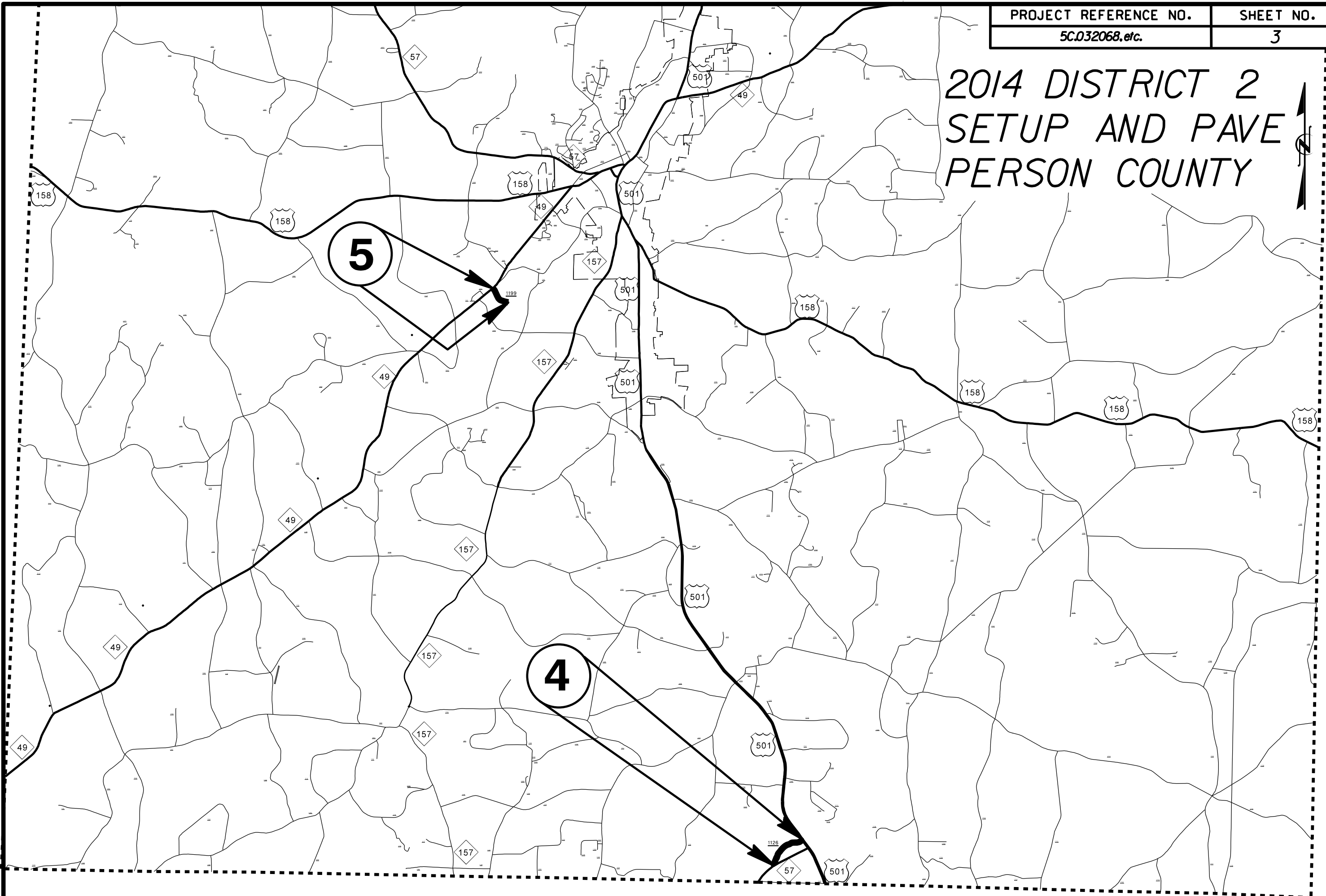

# PAVEMENT SCHEDULE

PROJECT REFERENCE NO.

SHEET NO.

5C.032068, etc

4

(C1)	PROP. APPROX. 2" ASPH. CONC. SURFACE COURSE, TYPE SF9.5A, AT AN AVERAGE RATE OF 220 LBS. PER SQ. YD.
(C2)	PROP. APPROX. 1 1/2" ASPH. CONC. SURFACE COURSE, TYPE SF9.5A, AT AN AVERAGE RATE OF 165 LBS. PER SQ. YD.
(P)	PRIME COAT AT THE RATE OF 0.35 GALLONS PER SQUARE YARD
(U1)	EXISTING SUBGRADE

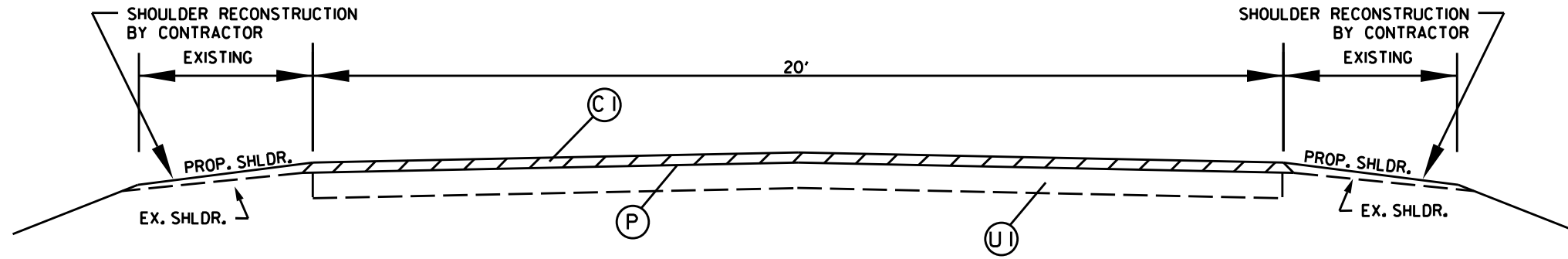

TYPICAL SECTION NO. 1

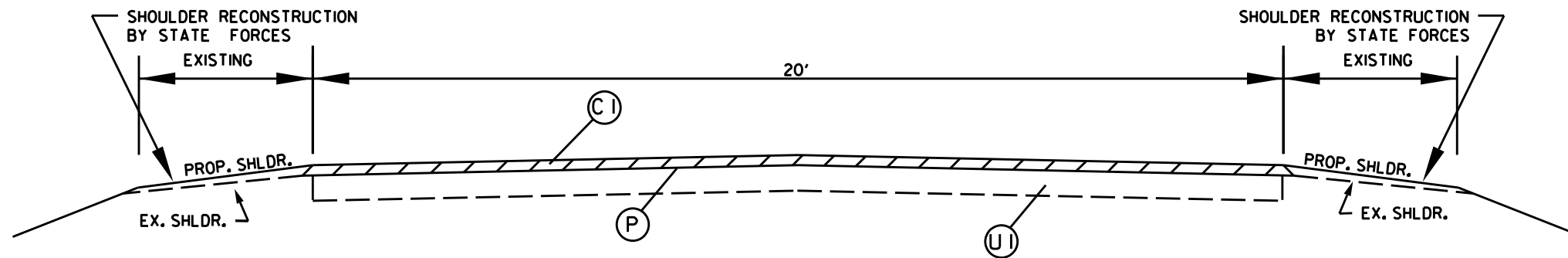

TYPICAL SECTION NO. 2

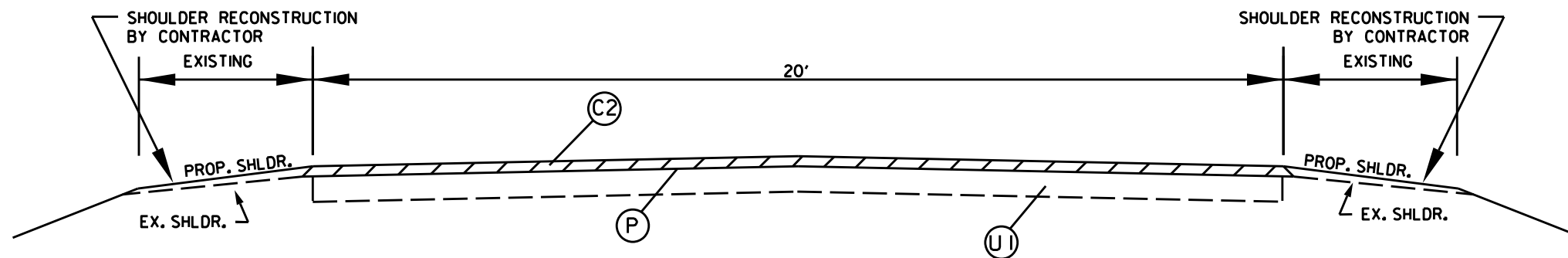

TYPICAL SECTION NO. 2

PROJECT NO.	SHEET NO.	TOTAL NO.
5C.032068, 5C.039048 5C.039049, ETC.		

### SUMMARY OF QUANTITIES

PROJECT NO	COUNTY	MAP NO	ROUTE	DESCRIPTION	TYP	LANES	LANE TYPE	FINAL SURFACE TESTING REQUIRED	WARM MIX ASPHALT REQUIRED	LENGTH MI	WIDTH FT	BORROW CY	GEOTEXTILE FOR SOIL STABILIZATION SY	REPAIR EXISTING AGGREGATE BASE COURSE TON	CONDITIONING EXISTING BASE MSY	INCIDENTAL STONE BASE TONS	SHOULDER RECONSTRUCTION SMI	PRIME COAT GAL	SURFACE COURSE, SF9.5A TON	ASPHALT BINDER FOR PLANT MIX TON	SEED & MULCHING AC
5C.032068	Durham	1	SR 1808 - BENNY ROSS ROAD	FROM BAPTIST ROAD		2		NO	NO	0.71	20	142	30.00	15	9		1.40	2,916	1,063	71	1.10
TOTAL FOR MAP NO. 1										0.71		142	30.00	15	9		1.40	2,916	1,063	71	1.10
TOTAL FOR PROJ NO. 5C.032068										0.71		142	30.00	15	9		1.40	2,916	1,063	71	1.10
5C.039048	Granville	2	SR 1627 MOSS LEDFORD ROAD	FROM SR 1625 TO DEAD END		2	2WU	NO	NO	0.7	20		100.00	50	10	20		2,875	938	63	
TOTAL FOR MAP NO. 2										0.7			100.00	50	10	20		2,875	938	63	
TOTAL FOR PROJ NO. 5C.039048										0.7			100.00	50	10	20		2,875	938	63	
5C.039049	Granville	3	SR 1148 RUSSELL ROAD	FROM SR 1138 CULBRETH ROAD TO DEAD END		2	2WU	NO	NO	0.9	20		100.00	50	15	20		3,696	1,206	81	
TOTAL FOR MAP NO. 3										0.9			100.00	50	15	20		3,696	1,206	81	
TOTAL FOR PROJ NO. 5C.039049										0.9			100.00	50	15	20		3,696	1,206	81	
5C.073060	Person	4	SR 1126 CHARLIE CASH ROAD	FROM US 501 TO NC 57		2	2WU	NO	NO	0.6	20	170	100.00	50	7	20	1.20	300	584	39	0.90
TOTAL FOR MAP NO. 4										0.6		170	100.00	50	7	20	1.20	300	584	39	0.90
TOTAL FOR PROJ NO. 5C.073060										0.6		170	100.00	50	7	20	1.20	300	584	39	0.90
5C.073063	Person	5	SR 1199 VANCE WRENN ROAD	FROM NC 49 TO CUL-DE-SAC		2	2WU	NO	NO	0.33	20	100	80.00	40	4	20	0.60	170	321	22	0.50
TOTAL FOR MAP NO. 5										0.33		100	80.00	40	4	20	0.60	170	321	22	0.50
TOTAL FOR PROJ NO. 5C.073063										0.33		100	80.00	40	4	20	0.60	170	321	22	0.50
<b>GRAND TOTAL</b>										<b>3.24</b>		<b>412</b>	<b>410.00</b>	<b>205</b>	<b>45</b>	<b>80</b>	<b>3.20</b>	<b>9,957</b>	<b>4,112</b>	<b>276</b>	<b>2.50</b>

### THERMOPLASTIC AND PAINT QUANTITIES

PROJECT NO	COUNTY	MAP NO	ROUTE	DESCRIPTION	TYP	LANES	LANE TYPE	LENGTH	WIDTH	4413000000-E WORK ZONE ADVANCE/ GENERAL WARNING SIGNING SF	4457000000-N TEMPORARY TRAFFIC CONTROL LS	4810000000-E 4" WHITE PAINT LF	4810000000-E 4" YELLOW PAINT LF
5C.032068	Durham	1	SR 1808 - BENNY ROSS ROAD	FROM BAPTIST ROAD		2		0.71	20	64	0.26	7,640	4,686
TOTAL FOR MAP NO. 1								0.71		64	0.26	7,640	4,686
TOTAL FOR PROJ NO. 5C.032068								0.71		64	0.26	7,640	4,686
5C.039048	Granville	2	SR 1627 MOSS LEDFORD ROAD	FROM SR 1625 TO DEAD END		2	2WU	0.7	20	64	0.23		
TOTAL FOR MAP NO. 2								0.7		64	0.23		
TOTAL FOR PROJ NO. 5C.039048								0.7		64	0.23		
5C.039049	Granville	3	SR 1148 RUSSELL ROAD	FROM SR 1138 CULBRETH ROAD TO DEAD END		2	2WU	0.9	20	64	0.29	19,368	11,880
TOTAL FOR MAP NO. 3								0.9		64	0.29	19,368	11,880
TOTAL FOR PROJ NO. 5C.039049								0.9		64	0.29	19,368	11,880
5C.073060	Person	4	SR 1126 CHARLIE CASH ROAD	FROM US 501 TO NC 57		2	2WU	0.6	20	64	0.14	12,912	7,920
TOTAL FOR MAP NO. 4								0.6		64	0.14	12,912	7,920
TOTAL FOR PROJ NO. 5C.073060								0.6		64	0.14	12,912	7,920
5C.073063	Person	5	SR 1199 VANCE WRENN ROAD	FROM NC 49 TO CUL-DE-SAC		2	2WU	0.33	20	64	0.08		
TOTAL FOR MAP NO. 5								0.33		64	0		
TOTAL FOR PROJ NO. 5C.073063								0.33		64	0		
<b>GRAND TOTAL</b>										<b>3.24</b>	<b>1</b>	<b>39,920</b>	<b>24,486</b>

- NOTES:  
 1) DETAIL DOES NOT APPLY TO OGAFB AND ULTRA-THIN BONDED WEARING COURSE.  
 2) BACKFILL SHOULDER WITH APPROVED MATERIAL.  
 3) THE SHOULDER WEDGE DEVICE MAY BE DISENGAGED AT PAVED DRIVEWAYS AND SIDE STREETS.

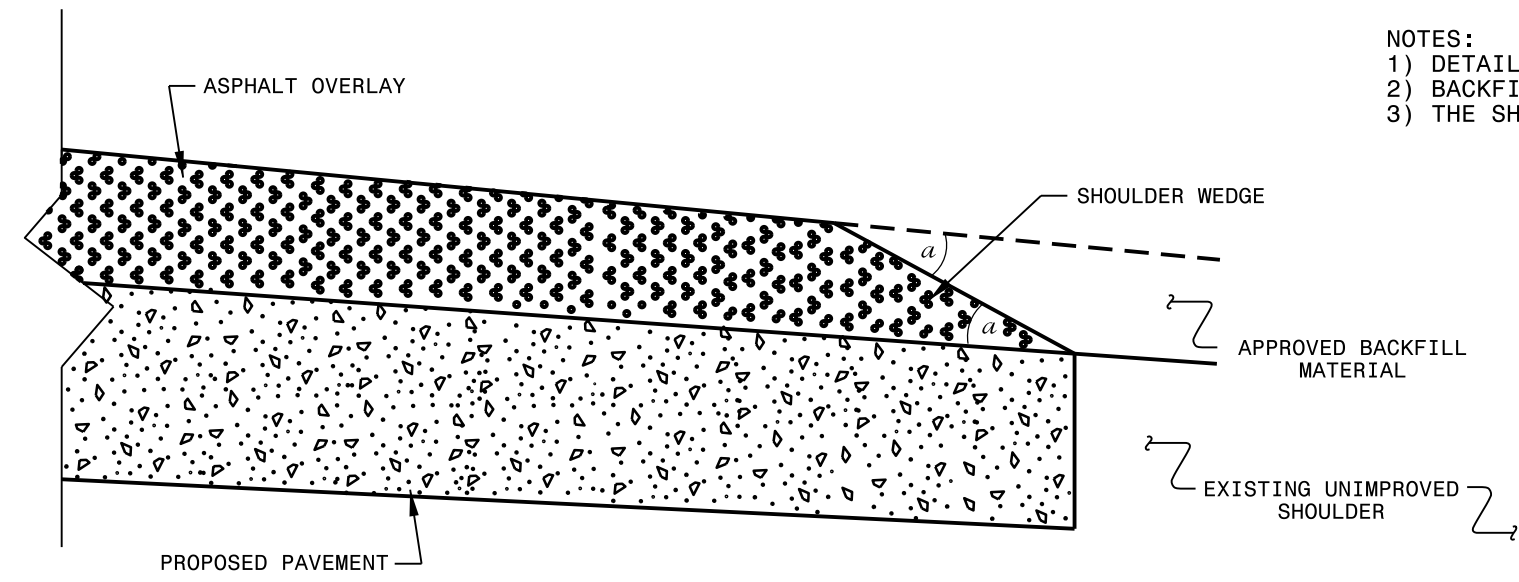

**SHOULDER WEDGE DETAIL**  
 (Resurfacing Projects w/ Widening or  
 with Existing Paved Shoulder having no dropoffs)

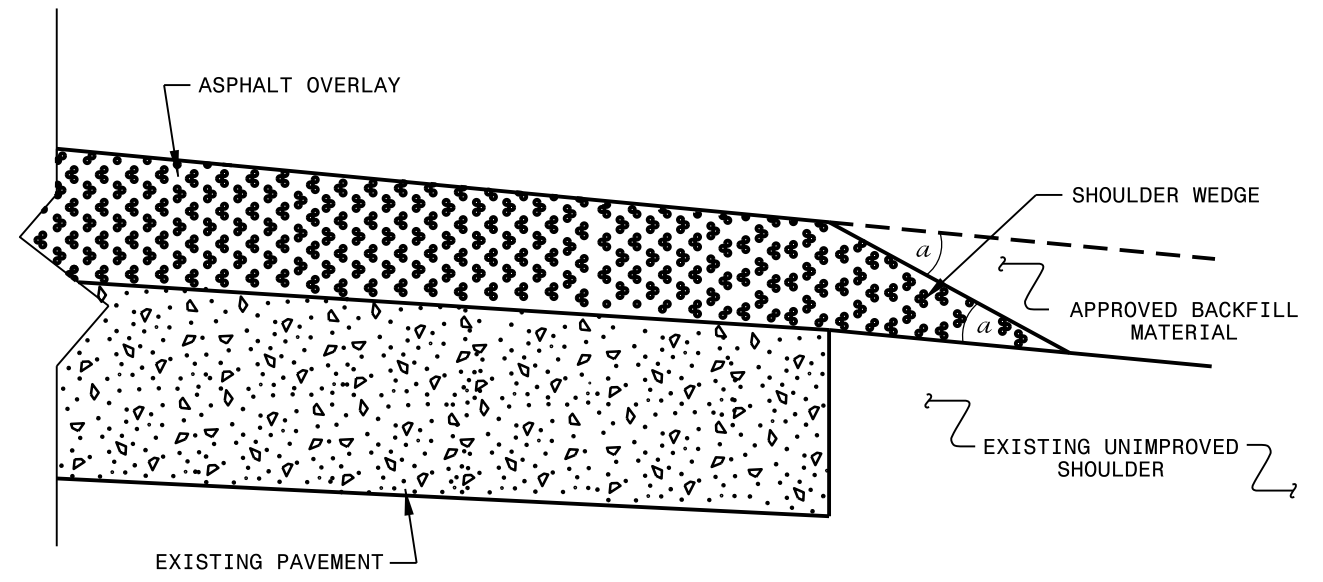

**SHOULDER WEDGE DETAIL**  
 (Resurfacing Projects w/ NO Widening)

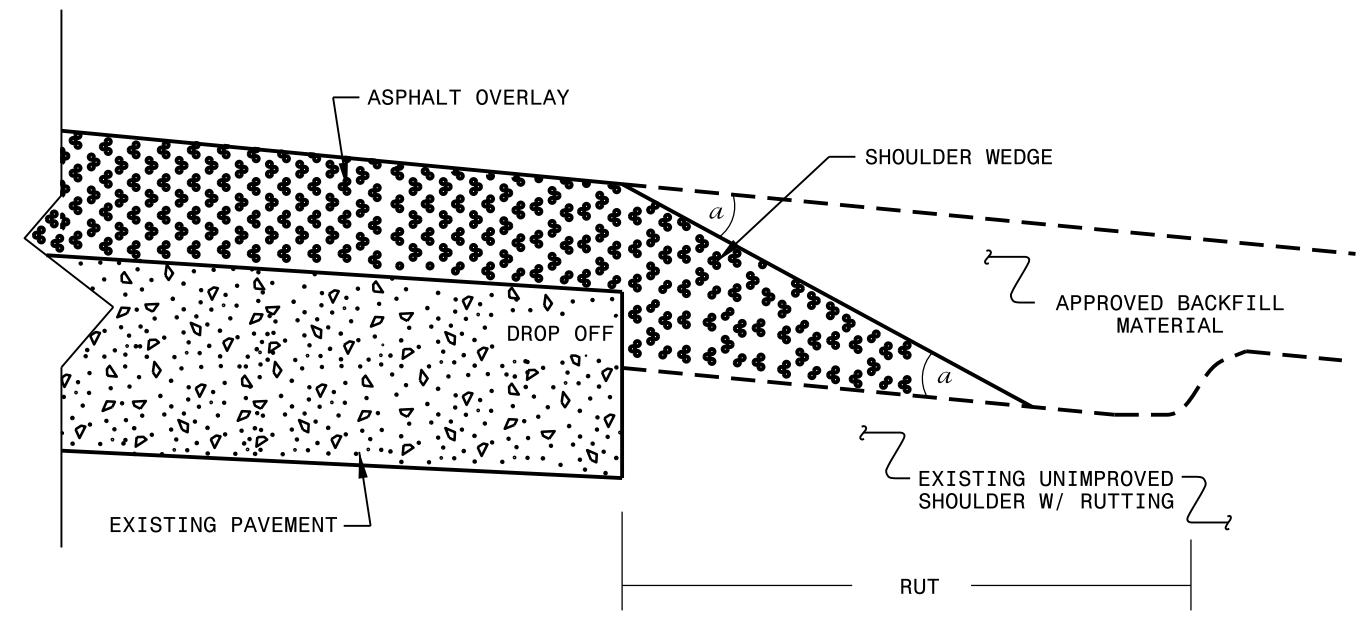

**SHOULDER WEDGE DETAIL**  
 (Resurfacing Adjacent to  
 Rutted Shoulder)

- SHOULDER WEDGE ANGLE = 30°

**CONTRACT STANDARDS  
 AND DEVELOPMENT UNIT**  
 Office 919-707-6950 FAX 919-250-4119

**SHOULDER WEDGE  
 DETAILS**

ORIGINAL BY: T.SPELL DATE: 7-19-11  
 MODIFIED BY: DATE: 10/16/12  
 CHECKED BY: DATE:  
 FILE SPEC.: susr/details/stand/shoulderwedgedetail.dgn

SYSTEM: \$\$\$\$  
 USER: \$\$\$\$  
 DATE: \$\$\$\$

**DIVISION OF HIGHWAYS  
STATE OF NORTH CAROLINA**

***SOIL STABILIZATION TIMEFRAMES***

<i>SITE DESCRIPTION</i>	<i>STABILIZATION TIME</i>	<i>TIMEFRAME EXCEPTIONS</i>
<b>PERIMETER DIKES, SWALES, DITCHES AND SLOPES</b>	<b>7 DAYS</b>	<b>NONE</b>
<b>HIGH QUALITY WATER (HOW) ZONES</b>	<b>7 DAYS</b>	<b>NONE</b>
<b>SLOPES STEEPER THAN 3:1</b>	<b>7 DAYS</b>	<b>IF SLOPES ARE 10' OR LESS IN LENGTH AND ARE NOT STEEPER THAN 2:1, 14 DAYS ARE ALLOWED.</b>
<b>SLOPES 3:1 OR FLATTER</b>	<b>14 DAYS</b>	<b>7 DAYS FOR SLOPES GREATER THAN 50' IN LENGTH.</b>
<b>ALL OTHER AREAS WITH SLOPES FLATTER THAN 4:1</b>	<b>14 DAYS</b>	<b>NONE, EXCEPT FOR PERIMETERS AND HOW ZONES.</b>

## SIGNING FOR RESURFACING PROJECTS

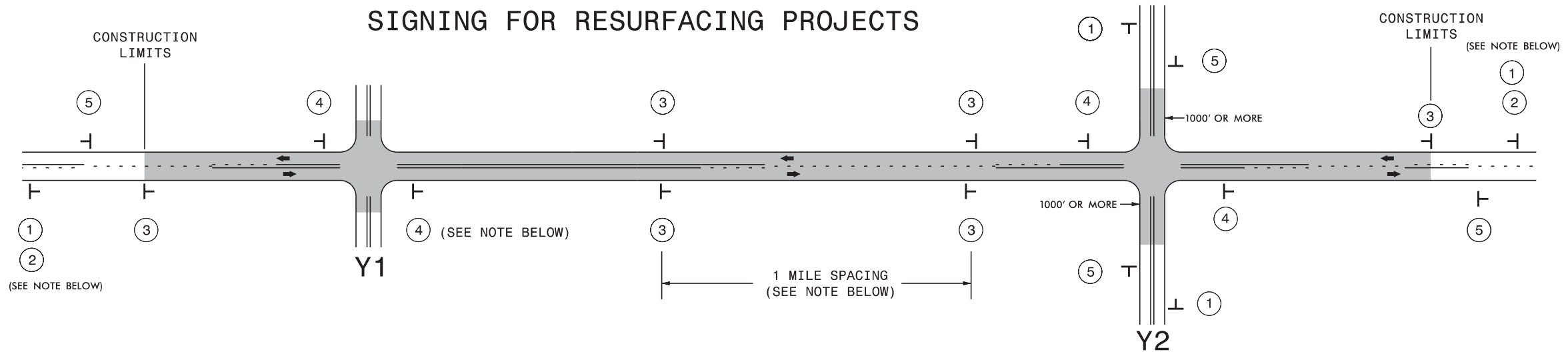

LEGEND	
┆	STATIONARY SIGN
←	DIRECTION OF TRAFFIC FLOW

### MAINLINE (-L-) SIGNING

### -Y- LINE SIGNING

SIGNING NOTES AND PLACEMENT PER DIRECTION	MAINLINE (-L-) SIGNING	-Y- LINE SIGNING
① ②	<p>PLACE 1000' PRIOR TO BEGINNING OF CONSTRUCTION LIMITS. ONLY USED ON -Y- LINES IF RESURFACING LIMITS EXTEND 1000' ALONG -Y- LINE.</p> <p>#2 SIGN ONLY USED WHEN RESURFACING LIMITS ARE 2 OR MORE MILES IN LENGTH. ROUND UP TO NEXT WHOLE NUMBER. (NO FRACTIONAL OR DECIMAL NUMBERS)</p>	<p>NO REQUIRED STATIONARY SIGNING FOR THE FOLLOWING -Y- LINE CONDITIONS:</p> <ol style="list-style-type: none"> <li>LESS THAN 1000' OF RESURFACING ALONG -Y- LINE</li> <li>SUBDIVISION ROADS</li> <li>DEAD END ROADS</li> </ol>
③	<p>PLACE INITIALLY AT THE CONSTRUCTION LIMITS AND SPACED 1 MILE APART THEREAFTER. IF NO -Y- LINES EXIST, PLACE 2ND SET 1/2 MILE FROM THE CONSTRUCTION LIMITS AND THEN SPACE 1 MILE THEREAFTER.</p>	<p>WHEN PAVING/CONSTRUCTION ACTIVITIES PROCEED ACROSS AN UNSIGNED -Y- LINE, ADVANCE WARNING PORTABLE SIGNS SHALL BE USED ALONG THE -Y- LINE AS SHOWN BELOW. REMOVE UPON COMPLETION OF WORK.</p>
④	<p>THESE ARE FOR -Y- LINES THAT ARE "THROUGH" ROADWAYS. DEAD END AND SUBDIVISION ROADS ARE NOT "THROUGH" ROADWAYS. INSTALL 500' +/- FROM EACH -Y- LINE APPROACH AS SHOWN ABOVE. FOR MULTIPLE -Y- LINES THAT ARE SEPARATED BY 0.25 MILES OR LESS, TREAT AS A SINGLE UNIT AND INSTALL WITHIN 500' OF EACH APPROACH. A MAXIMUM OF 2 SIGN SETS PER MILE. DO NOT INSTALL WHEN -Y- LINES ARE WITHIN 0.5 MILES FROM "END ROAD WORK" SIGN.</p>	<p>PLACED 500' IN ADVANCE OF FLAGGER. PLACED 250' IN ADVANCE OF FLAGGER.</p>
⑤	<p>PLACE 500' FOLLOWING THE END OF CONSTRUCTION LIMITS.</p>	

8/8/2013 S:\TMU\WZTC\Resurfacing\2013Documents\New\_Procedures\_05\_09\_2013\Resurfacing\_AdvWarn\_2Ln.dgn User:rmgarratt

**RESURFACING  
ADVANCE WARNING SIGNS  
FOR  
RURAL AND SUBURBAN  
2 LANE ROADWAYS**